

SPECIAL FILTERS JF-50 thru JF-200

Our upgraded Series JF-50 to Series JF-200 filters give you great performance at economical prices. We offer five sizes in a variety of configurations for every filtration need. Our filters feature mechanical, chemical and combination of both to suit your needs. All models are SALTWATER SAFE and are made completely of non-toxic and non-corroding materials.



Series JF-50 Filter with Cores:
Carbon / Biologic core basket, filter and
mechanical element

Series JF-50 thru JF-200 filters feature:

- 2" female-pipe threaded inlet and outlet.
- Available 2" FPT drain with cap.
- Includes dial-type pressure gauge.
- Rated to handle up to 35-psi.
- Cleaning and/or replacement of element or media can be performed without removing complete filter from the system.
- No tools required to maintain all models except JF-50MC, JF-80MC and JF-120MC (requires standard flathead screwdriver to change granular media).
- Limited 1-year warranty on all filter canister shell.



JF-80 thru JF-200 Filters

Models Available:

- **Chemical Filter.** The ideal high-capacity, high-flow-rate filter for multi-tank recirculating systems. The special cylindrical chemical retainer gives ideal surface area to flow characteristics, which allows use of large quantities of chemical with minimal flow restriction. Any chemical, rice-grain size or larger, (media not included) can be used conjunction with retainer bag. (Models JF-50C, JF-80C, JF-120C, JF-160C or JF-200C)
- **Biologic (Gravel) Filter.** Has the same features as our chemical filter, but the filtrate retainer is of a coarser mesh. Designed for use with gravel, crushed lava, coral, zeolite, marble chips, dolomite, bioballs or other media with a minimum particle size of 1/4" (media not included). Offers better depth retention of particulates without clogging where water conditions are very turbid. Designed for primary mechanical filtering of outdoor ponds or for biologic filtration of any system. (Models JF-50C, JF-80C, JF-120C, JF-160C or JF-200C).
- **Mechanical Filter.** Uses a permanent 16-micron polyester, reusable pleated element (included) for particulate filtration. (Models JF-50M, JF-80M, JF-120M, JF-160M or JF-200M)
- **Combination Mechanical-Chemical Filter.** Uses the same pleated element (included) as the mechanical filter plus a special chemical chamber in the element core to hold granulated activated carbon or equivalent (media not included). (Models JF-50MC, JF-80MC and JF-120MC) (JF-160 and JF-200 Combination Mechanical-Chemical Filter not available).

READ AND FOLLOW ALL SAFETY INSTRUCTIONS ON PAGE 2



Carbon / Biologic (Gravel) Models

MODEL	Media Capacity	Maximum Flow (gpm)	Size (Diameter x Height)	Ship Wt (lb)
JF-50C	15 lbs	50	14" x 17"	18
JF-80C	22 lbs	80	15" x 25¼"	22
JF-120C	30 lbs	120	15" x 30¼"	25
JF-160C	45 lbs	160	15" x 35"	28
JF-200C	55 lbs	200	15" x 40¼"	32

Mechanical Models

JF-50M	JF50MO / 50 sq ft	50	14" x 17"	18
JF-80M	JF80MO / 80 sq ft	80	15" x 25¼"	22
JF-120M	JF120MO / 120 sq ft	120	15" x 30¼"	25
JF-160M	JF160MO / 160 sq ft	160	15" x 35"	28
JF-200M	JF200MO / 200 sq ft	200	15" x 40¼"	32

Combination Mechanical-Chemical Models

JF-50MC	JF50MO-50 sq ft / 4 lb	50	14" x 17"	18
JF-80MC	JF80MO-80 sq ft /	80	15" x 25¼"	22
JF-120MC	JF120MO-120 sq ft / 8 lb	120	15" x 30¼"	25

NOTES:

- Specifications subject to change without notice.
- Dimensional weight applies for all priority shipping.
- One pleated element included and installed on all models using element.
- Activated carbon, biologic media, gravel, etc., not included. Media available at additional cost.

SAFETY INSTRUCTIONS:

- This filter is designed for a maximum operating pressure of **35 psi** with a bursting pressure of 50 psi—Under NO circumstances should it be connected to any type of high pressure pump or directly to a municipal water system.
- Do not subject filter to freezing temperatures with water in it.
- Always open air bleed valve when filling the unit with water to avoid air-hammer effect which may cause the filter to explode.
- Always make sure that lid nut is fully tightened before using filter.

Plumbing & Installation:

The models JF-50 thru JF-200 Filters are provided with a 2" female pipe thread fitting. If smaller connections are required, reducing bushing are available from Aqua Logic or most plumbing supply stores. When making threaded connections with plastic fittings, use Teflon tape or an approved plastic pipe sealant. If this filter is to be installed below a tank or below water level, shut-off valves should be installed on both the inlet and outlet side of the filter to isolate the water from the filter and other components to prevent backflow of water during repair or maintenance.

This filter should be installed on the discharge (pressure) side of the pump. Do not install this (or any) filter on the suction side of the pump or damage to the pump may occur!

We recommend installing pipe union fittings on both inlet and outlet of the filter for easy future removal of the unit from your system. This will prevent having to cut pipes to remove the filter.

Startup:

- Check to make sure lid is on filter correctly with lid nut tightened all the way.
- Open air vent valve (small valve on lid).
- Open main/inlet/outlet shut-off valves (if used).
- Start pump.
- Close air vent valve on lid when water begins to squirt out of vent valve.

Removing Filter Element or Media Cores:

- Make sure that pump is turned off.
- Drain filter.
- Close inlet/outlet filter shut-off valves (if used).
- Open air vent valve on top of lid.
- Press yellow tab on lid nut.
- Unscrew and remove lid nut from filter top.
- Pull up on one of the handles on the lid. If stuck, bump the handle firmly with the butt of your hand. Do NOT use a hammer or other hard tool.
- After lid is removed, remove filter core by lifting core or element on its sides.

Removing Element from Core:

- Hold core in place on the floor while lifting element off of core.

Removing Chemical Retainer Plate:

(Models JF-50MC, JF-80MC or JF-120MC)

- Turn element retainer core upside down and use flat-head screwdriver to remove all stainless-steel screws.
- Remove activated carbon or other media retainer bag.

Open Carbon or Gravel Retainer Basket:

(Models JF-50C, JF-80C, JF-120C, JF-160C or JF-200C)

- Remove basket from filter shell.
- Unscrew center cap from basket lid.
- Pour out media from the basket.

Element Cleaning Instructions:

(Models 264, 265, 364, 365, 464, 564)

These models use an include high-capacity 16-micron polyester reuseable element to remove microscopic suspended particulates. It is designed to last for several years if cleaned and maintained properly. As the filter removes dirt, it begins to accumulate on the element creating a resistance to water flow and thus a drop in the volume of water passing through the filter. As water flow goes down, the reading on the pressure gauge goes up. When the reading is **3 or 4 psi higher** than when the element is clean, it is time to clean the element. When flow decreases below the desired rate, cleaning or replacement of the element is necessary. Elements are usually cleaned by use of a pressure nozzle on a garden hose. To remove dirt, direct the water jet inside and then outside of the element at an angle working from top to bottom. This is usually sufficient to clean dirt and other particulates from the element. Organic materials may impregnate into the fibers of the element after extended use and cannot be removed by mechanical cleaning as described above.

To clean the element of organic accumulations, the element must be soaked overnight in a 25% chlorine solution (3 parts water, 1 part chlorine bleach). Be sure to use a pure bleach with no cleaning or fragrance additives. After soaking, the element should be very carefully rinsed. The element should be rinsed until the chlorine aroma is gone. You may also use a dechlorinator or Amquel[®] to neutralize the chlorine.

For best results, we recommend that the element be kept damp once it has become wet.

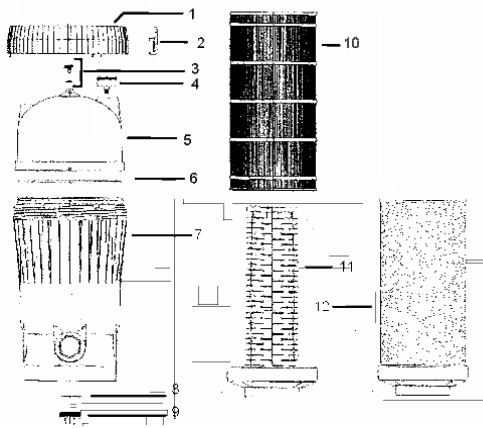

JF-80 thru JF-200 Parts

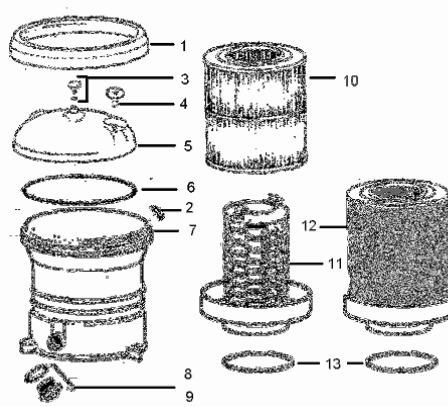

JF-50 Parts

		MODEL	JF50	JF80	JF120	JF160	JF200
1	Lid Ring		42285007	42367102	42367102	42367102	42285007
2	Lock Tab		43309202	42367706	42367706	42367706	42360107
3	Air Bleed w/O-Ring		39254701	39254701	39254701	39254701	39254701
4	Pressure Gauge (0-60)		91934182	91934182	91934182	91934182	91934182
5	Lid		42285205	42299800	42361000	423661101	422825205
6	Lid O-Ring		47038047	47038047	47038047	47038047	47038047
7	Canister Body		42289306	42367300	42367300	42367300	42289306
8-9	Drain Plug w/O-Ring		43309202	43309202	43309202	43309202	43309202
10	Element, 16-micron	JF-50M JF-50MC JF-80M JF-80MC JF-120M JF-120MC JF-160M JF-200M	JF50MO JF50MO	JF80MO JF80MO	JF120MO JF120MO	JF160MO	JF200MO
11	Element Core	JF-50M JF-80M JF-120M JF-160M JF-200M	42360107	42294603	42294702	42373902	42374009
11a	Element Core + Carbon Retainer	JF-50MC JF-80MC JF-120MC	JF50MCO	JF80MCO	JF120MCO	J NA	NA
12	Media Basket	JF-50C JF-80C JF-120C JF-160C JF-200C	JF50CO	JF80CO	JF120CO	JF160CO	JF200CO
13	Seating O-Ring		47025853	NA	NA	NA	NA
14	Carbon Screen*		X65SCR	X65SCR	X65SCR	NA	NA
15	Carbon Screen Screws*		X65-Screw	X65-Screw	X65-Screw	NA	NA

* (not shown). Used only on JF-50MC, JF-80MC and JF-120MC filters. Mounts on JF50MCO, JF80MCO and JF120MCO cores.

* (not shown). Stainless steel screws are used to attach carbon screen to element-carbon core. Sold only as a 9-screw set.



Limited Warranty Terms (PLEASE READ CAREFULLY):

All filters manufactured by *AQUA LOGIC, INC* (hereafter called *AQUA LOGIC*) are warranted against defects and workmanship for a period of one (1) year from the date of purchase by the original purchaser/enduser. Any *AQUA LOGIC* product found to be defective within the warranty period will be repaired or replaced at the option of *AQUA LOGIC*.

Warranty EXCEPTIONS:

- The warranty applies only to the original enduser and is not transferable.
- The limited warranty may not be modified by verbal statements by the manufacturer, distributors, retailers, their agents nor any other party.
- The warranty covers only the repair or replacement of the *AQUA LOGIC* product. *AQUA LOGIC* denies all liability for any other loss including but not limited to loss of equipment, income, livestock or personal injury.
- *AQUA LOGIC* does not warrant the suitability of the product for the enduser's application.
- All warranties are voided by the following:
 - Product labels defaced or removed.
 - Product improperly installed or maintained by user or their agent.
 - Product abused, misused, or damaged by user.
 - Product misapplied to application.
 - Product damage caused by electrical surges, spikes, brownouts or improper voltage.
 - Product damage caused by freezing, extremely cold or extremely high temperatures.
- *AQUA LOGIC* shall not be liable for the cost of field repairs, inspection, installation, replacement, etc., without prior written authorization and/or valid authorization number.
- *AQUA LOGIC* shall not be liable for shipping damage or loss.
- *AQUA LOGIC* shall not be liable for unauthorized shipping costs to return warranty items to *AQUA LOGIC*.